

KASFAA FALL CONFERENCE 2019

October 9 – 11, 2019



Holiday Inn Louisville East

Louisville, Kentucky

President's Welcome



Welcome to the Fall 2019, "Go Into the Light With KASFAA". I hope you enjoy a conference that we feel is packed with excellent sessions, great fun, and maybe a few scares. I want to thank you for the opportunity to serve you as President for the 2019-2020 year. The goal for this year is to provide training opportunities for everyone who is involved with financial aid, and to provide tools needed to make sure your office is in compliance and have the tools needed to be successful. As financial aid offices seem to be shrinking, and we are expected to do more with less, we are now tasked with extra duties that in the past were not part of our daily responsibilities.

The theme for the conference is "Go Into the Light". We are constantly challenged with new regulations and new tasks that make us nervous, scared, and cause us to lose sleep. The conference will provide you with the light and knowledge to take on those challenges and to help your students. The fall conference committee has planned frightful sessions that will provide you with valuable information. We have several guest speakers with us this week, so please welcome them to KASFAA. We have NASFAA U sessions scheduled for pre and post conference times. In between your sessions, please stop by our vendor area. We are grateful to our Vendors for the continued support of KASFAA.

You will have plenty of opportunities to network with colleagues and catch up with friends: The Spooktacular President's Reception on Wednesday night, the ghoulish luncheon on Thursday and the Halloween Costume Party Thursday night!

I want to personally welcome all of our first time conference attendees and new aid officers! We are excited you are here. I hope that you meet many of the excellent people who work with financial aid every day, who care for their students, and can offer friendly advice as well as a contact that you can call upon should you come across an issue that you need another person's perspective.

Lastly, please read about our charity, Family Scholars House, as there will be multiple opportunities to support this wonderful cause throughout the conference.

Bob Fultz
2019-2020 KASFAA President



PROGRAM COMMITTEE



The time is drawing near and you are afraid to walk out into the dark!! Don't be afraid as our Fall 2019 Program Committee has planned an eye - opening conference to bring you into the light! You will learn how to help all the varying creatures of the night with Deondra Wardell's enlightening opening session, Communication with Diverse Social Economic Groups! Don't run from our Favorite FED David Bartnicki, he isn't *that* scary, and can calm your fears as he shares on overawards & overpayments, adds, drops and withdrawals, R2T4, Academic Calendars, and of course our Federal update. Dana Kelly will put a spell on you with Administrative Capabilities and Consumer info and our concurrent sessions are packed with frightful awakenings like Data Sharing, Student Loan Letters, Majoring in Money, Cyber Security and more. These sessions will help you to feel *alive* again in completing your job!!

After being released from your session bonds, enjoy the Wednesday evening game night with your fellow Financial Aid friends and don't forget to bring your favorite costume for the Thursday evening Halloween Party and Trivia. You could just be the spookiest ghou! around!!

Thanks to the "village" for making it happen. It couldn't have been done without you!! Special thanks to Janet Jones for helping me with the program! You are a good witch!!

Terri Jo Thomas Fall 2019 Program Chair

2019-2020 Conference Committee Members

Bob Fultz	Georgetown College
Michelle Standridge	Spalding University
Beth Mitchell	Transylvania University
Hannah Mullins	Georgetown College
Mark Messingschlager	Thomas More University
Rhonda Bryant	University of Kentucky
Anna Beth Mekus	University of Kentucky
Kevin Lamb	Centre College
Janet Graham Jones	University of Kentucky
Chester Priest	KHEAA/KHESLC
Bryan Erslan	Eastern Kentucky University
Lauren Frye	Georgetown College
Erin Connor	Berea College
Sarah Cowan	Galen College of Nursing
April Tretter	Bellarmine University
Michael Birchett	Bluegrass Community and Technical College
Crystal Hamilton	Kentucky Wesleyan College
Cathy Hart	Bluegrass Community and Technical College
Angel Miller	Sullivan University

My apologies if I left anyone out...THANK YOU ALL FOR YOUR COMMITMENT AND HELP!!

CHARITY



The mission of Family Scholar House is to end the cycle of poverty and transform our community by empowering families and youth to succeed in education and achieve life-long self-sufficiency.

Each year, we serve disadvantaged residential and nonresidential single moms and dads and their children with a comprehensive, holistic continuum of care that meets them where they are and empowers them toward their educational, career and family goals.

All families have experienced poverty, unstable housing and, most often, domestic violence. Programs and services are responsive to the needs of families and are provided for all ages.

An example of how our dollars can help:

\$30.00 provides monthly support services a pre-residential family needs to be college-ready while waiting to live at Family Scholar House.

\$90.00 provides monthly funding needed for programs that promote health, wellness, self-esteem and family bonding.

\$200.00 provides all of the vital academic and family services necessary for a residential family to excel in the classroom and succeed in life for one month.

Mailing Address:

Family Scholar House
403 Reg Smith Circle
Louisville, KY 40208

Opportunities to support Family Scholar House:

- Donations: We are looking for donations/baskets from schools for the silent auction. Additionally, we are also encouraging smaller item donations from schools or individuals, that can be used as raffle giveaways.
- Halloween Party on Thursday night, we will have a Costume contest where you give a \$1.00 to the person wearing your favorite costume. Whomever has the most dollars wins a prize and then the funds will be donated to Scholar House
- Cash: We encourage you to bring cash to participate in the silent auction, raffle and costume contest!
- Visit the website, [Family Scholar House](http://FamilyScholarHouse.com) for more information on their services.

Platinum Sponsors



Gold Sponsors



Silver Sponsor



Bronze Sponsors



Bronze Sponsors



A special thank you goes to all of our exhibitors who have helped to offset the cost of this conference. Your continued support is greatly appreciated!

CONFERENCE INFORMATION AND REMINDERS

Conference Attire: Dress for the entire conference is business casual. Remember that meeting rooms and conference facilities can be cool. Wear layered clothing for your comfort. Friday is Spirit Day so wear your school colors.

Name Badges: Name badges must be worn for admission to all conference sessions and functions. If you misplace your name badge, please go to the conference registration area.

Name Badge Ribbons: You can identify some groups of KASFAA members by the ribbon attached to their name badges:

Past Presidents	Light Blue	New Members	Red
Executive Board Members	Dark Blue	Exhibitors	Purple
Program Committee Members	Green		

Meal Tickets: Your conference name badge is your meal ticket. Your name badge must be worn for admission to all meal functions. If you would prefer a vegetarian meal, please contact a member of the program committee.

Evaluations: Please take the time to complete your conference evaluation, including suggestions for future topics. These evaluations are important to the success of future conferences. The evaluation form will be available on the tables Friday morning and will also be available online during and after the conference.

Meeting Etiquette: Please remember to silence your phone during conference functions. Also, please refrain from talking during presentations, and remember, loud conversations held outside of a meeting room can be disruptive to others.

Wednesday Game Night: Bring your favorite games to play with your fellow financial aid friends

Thursday Halloween Party: Don't forget your costumes and dollar bills to vote for your favorite





David Bartnicki

David has worked for the U.S. Department of Education's Federal Student Aid Office for over 25 years. He has served as an Institutional Review Specialist, Institutional Improvement Specialist (IIS), Branch Chief for Contract Compliance and is currently a Federal Training Officer.

David's entire government career has been in the Atlanta Regional Office where he currently works with over 6,000 postsecondary schools across the country. As a training officer, David provides training and technical assistance on a wide variety of federal student aid topics to schools, state agencies, accreditation bodies and higher education organizations through a

variety of state, regional, national and Department venues.

While in FSA, David has helped redesign the FSA Assessment Modules, developed the popular "Ask A FED" booth at the annual FSA Conferences, and developed the Department's compliance review process for ED's private collection agencies. David serves on the Conference Delivery Team, FSA Fundamentals Redesign Team, and the National Verification Team.

In addition, David has received numerous financial aid awards including the 2016 GASFAA (GA) Service Award, the 2014 Certificate of Recognition from the State of Alabama Governor Bentley's Office; 2013 FSA Award for Most Innovative Team, 2013 FASFAA Distinguished Service Award (FL), 2013 TASFAA Distinguished Service Award (TN), the 2012 SASFAA Distinguished Service Award (Southern Regional), the 2012 AASFAA John H. Buchanan Distinguished Service Award (AL), 2012 MASFAA Special Recognition Award (MS), the 2011 Kentucky "Admiral" Award, 2010 FSA Award for Best Mission Results, the 2005 Florida Public Career Technical Center's Merit Award, the 2003 SCASFAA Distinguished Service Award (SC), the 2003 AASFAA Award of Merit (AL) and the 2001 NCASFAA Award of Merit (NC).

When not working, David enjoys spending time with his wife, Christy, and sons Luke (19), Adam (19), and Ethan (15). And of course, Zyke, the world's cutest dog!



Deondra R. Wardelle is a leader, organizer, corporate trainer, licensed health coach, problem solver, motivational speaker and continuous improvement professional. Her focus is coaching, empowering and developing individuals towards achieving their personal and professional goals.

Deondra has a diverse professional background that includes her current role as the Vice President of Human Resources and Continuous Improvement and her immediate past role as Director for a global industry leader, where she and her team were responsible for driving and supporting Continuous Improvement opportunities for more than 70 facilities in North America, Europe and Asia. In addition, she has worked as a corporate trainer, human resources professional, project manager and has held various roles in operations management.

Born in California, raised in Kentucky and now living in Indiana. Deondra graduated from Western Kentucky University with a Bachelor of Arts degree in Corporate & Organizational Communication, has studied Leadership at the Louisville Southern Baptist Theological Seminary and earned her Health Coach certification from the Institute of Integrative Nutrition.

As a licensed Health Coach, Improvement Kata Coach and Lean Six Sigma professional (specializing in Lean Six Sigma and the Toyota Improvement and Coaching Kata) Deondra's passion and life's calling is using Continuous Improvement methodologies to help organizations in varying industries achieve their strategic goals in conjunction with exceeding the expectations of both their internal and external customers.



Dana Kelly - Dana has over 25 years of experience working in the higher education community and has been active in multiple state and regional associations. She was recently promoted at NASFAA to Vice President for Professional Development and Institutional Compliance. She is a former President of NCASFSA and has been an active member of SASFAA. Prior to joining NASFAA, Dana held positions covering many sides of student aid. She served as the Director of Financial Planning at High Point University in North Carolina for 12 years and worked on both the Lender and Servicer side of financial aid, most recently for Nelnet. She received her Bachelor's of Science degree from Guilford College and she holds a Master's in Public Administration and a Master's in Organizational Management. Dana has a daughter, Sloane, now a freshman in college. She is by far her greatest accomplishment. Dana also has a 4-legged daughter, Allie, who is more person than dog and who is currently upset Mom is visiting her friends in Kentucky!



Bryan Erslan – Bryan is currently the Director of Student Financial Assistance at Eastern Kentucky University. He has over 28 years of higher education experience and has served as a Director of Financial Aid at two additional schools, Lincoln Memorial University and Berea College and other admissions and financial aid positions throughout his career at Union College (KY), University of Rio (rhymes with Ohio) Grande (OH), The University of Dayton and The University of Tennessee-Knoxville.

Throughout his career he has been very active promoting access to higher education for students with great need. He has served in numerous leadership roles within state, regional and national associations, including Past President of KASFSA. Currently, he is serving as President of the Southern Association of Student Financial Aid Administrators, which includes nine southeast states. Bryan has been married to his wife Micki for twenty-seven years and have four children, three daughters and one son. In his spare time, he enjoys spending time with his family, traveling and playing golf.



Danette Seale - Danette is the Executive Director of Financial Aid at Carson-Newman University located in Jefferson City, TN. She is currently serving as the President-elect of the Tennessee Association of Student Financial Aid Administrators (TASFSA) and has served TASFSA in various other capacities such as Conference Chair, Sponsorship Chair, and Private Four-Year Sector Representative. She received her B.S in Business Economics from Carson-Newman College in 1993, and her MBA from Carson-Newman University in 2014. She began her career in financial aid at Carson-Newman before her freshman year in the fall of 1989 as a Federal Work-Study student and became a full-time member in 1992 while continuing to work on her degree. She was the first person to hold the title of Associate Director in the office before resigning to become a stay at home mom with the birth of her third child. After a glorious two years of working as a stay at home mom, she returned to her

alma mater during awarding season in 2002 and was promoted to director in 2006. She was chosen by the Carson-Newman President in 2013 to receive his C-N Rebar All-Star Excellence & Friendly Service Award. The award actually has a piece of rebar on the plaque personally cut by the president himself. Who knew presidents cut rebar? Besides having a passion for helping students, she is an instructor for Foxey Moxey Fitness, and a certified Strong by Zumba instructor. She enjoys hiking, biking, and paddle boarding, and is also an avid sports fan who loves cheering on the TN Vols, Carolina Tarheels, Carolina Panthers, and of course the C-N Eagles, but also just loves watching a good game no matter who is playing. She resides in Jefferson City, TN with her husband, Danny, her sons Colton and Grant, her daughter Olivia, their Great Pyrenees dogs Jack and Mack, more cats than she would like, and a whole herd of hair sheep on English View Farm.

OTHER SPECIAL GUESTS:

Dr. LaVena Wilkin, Director of the PhD and Graduate Management programs at Sullivan University

Dr. Wilkin has held this position since June 2013. Before joining Sullivan University, she spent twenty-six years in the construction industry, and three of those years she co-owned a commercial masonry sub-contracting company. After selling the construction company in 2001, she came to work full-time at Sullivan serving as the Associate Director of the Evening and Weekend Division. She was also the Dean of the College of Business for Sullivan University for three years and the Dean of Conflict Management programs for five years.

LaVena has facilitated workshops on conflict styles, workplace bullying, forgiveness, emotional intelligence, organizational conflict, conflict and change, employee engagement, dealing with difficult people, and the P.E.A.C.E. © Model of Conflict Management. She is also co-editor of a book entitled Organizational Conflicts: Challenges and Solutions. She contributed a chapter in the book, The Mediation Handbook: Theory, Research and Practice. Her co-edited book, From Discord to Harmony: Making Your Workplace Hum, is scheduled to be published in December 2019. Finally, she is the Editor for the Journal of Conflict Management, a scholarly journal that publishes research in many of the multidisciplinary areas of managing conflicts.

LaVena is the Vice-President for the Board of Directors at Unity of East Louisville. Additionally, she previously served on the Board of Directors for the Society for the Prevention and Aggression Among Adolescence (SPAIVA). LaVena and her husband, Bob, have been married for almost sixteen years. They appreciate Friday Night Dates where they experience the excellent restaurants around Louisville. She also enjoys playing tennis, reading, and spending time with family and friends.

K. Sean McGreevey, Ph.D., Dean of Students Bellarmine University

Dr. Sean McGreevey is a student affairs administrative leader serving institutions for over 20 years and currently leads Bellarmine University as Dean of Students. In his current role, he is the chief conduct officer and chairs The Behavioral Intervention Team while supervising 5 functional areas in student affairs. He also teaches as clinical faculty in the Masters of Higher Education and Social Justice program at Bellarmine. Sean served as Assistant Dean at Chatham University (Pittsburgh), Director of Residence Life at Young Harris College (Georgia) and Assistant Director for Resident Student Learning at The University of South Carolina. He earned a Ph.D. in Higher Education Administration from The University of South Carolina and a Masters in College Student Personnel at Bowling Green State University in Ohio.

Dr. Laura Smith, Vice President of Student Affairs at Jefferson Community and Technical College

Laura is originally from Radford, Virginia and came to Kentucky as an undergraduate at Cumberland College where she earned a B.S. in Communication and Theatre Arts. She went on to the University of Louisville to obtain a Masters in College Student Personnel. Her career in Student Affairs began at Spalding University where she served as Director of Residence Life, Director of Student Leadership and Activities, and finally as Assistant Dean of Students. She was then able to transfer her experiences in student development to leading professional

staff when she was named Dean of Students at Ivy Tech State College in Sellersburg, Indiana. She went on to earn her Ph.D. in Leadership in Higher Education Administration from Indiana State University. In 2005 Laura joined KCTCS as Dean of Students at Jefferson and in 2017 was promoted to Vice President of Student Affairs. Laura has been at the forefront of retention and student success initiatives at Jefferson. She is a passionate student advocate and champion for equity and inclusion.

Richard Hudson, Ph.D., LPCC, Dean of Students/Title IX Coordinato, Spalding University

Richard Hudson has served as Dean of Students at Spalding University since 2006. He holds a doctorate in Counseling Psychology from the University of Louisville and master's degrees in Education and Rehabilitation Counseling from University of Louisville and University of Kentucky respectively. He attended Murray State University for his undergraduate studies. Prior to his current role at Spalding University Richard's work focused on serving individuals with disabilities as Clinical Director for the Kentucky Autism Training Center, counselor with the Kentucky Department of Vocational Rehabilitation and clinical internship at Gallaudet University in Washington D.C. In addition to his role as the Dean of Students, Rick also teaches several courses in the undergraduate psychology program.

Sarah Heberd, Assistant Director of Academic and Membership Affairs, NCAA

Sarah Heberd is currently a member of the Division I Academic and Membership Affairs team at the NCAA. Prior to the NCAA Sarah has worked in the compliance department at two Division I institutions, the University of Georgia and the University of North Carolina, Charlotte.

Galen College of Nursing Students:

Jessica Cates, Associate Degree in Nursing student, Galen College of Nursing

Jonathan Garner, Bachelor of Science in Nursing student, Galen College of Nursing

Elaine Harkey, Bachelor of Science in Nursing student, Galen College of Nursing

Leslie Sprague, Bachelor of Science in Nursing student, Galen College of Nursing

Thank you to all our special guests for taking the time to attend our conference and making it so great!!

CONCURRENT SESSIONS AT A GLANCE

	Wednesday October 09 4:15 – 5:15 p.m.	Thursday October 10 10:45 – 11:45 a.m.	Thursday October 10 3:00 – 4:00 p.m.	Thursday October 10 4:15 – 5:15 p.m.
Ellis Room	Administrative Capabilities	Consumer Info	Majoring in Money 2019	From Discord to Harmony: Five Strategies for Making Your Workplace Hum
Derby	Data Sharing Best Practices	KHEAA KY National Guard processing changes	KAHOOT Veri' Fried'	Recognizing Hidden Bias in Professional Judgement
Turfway	Roadmap to Effective Emergency Aid	Student Loan Letters School Perspective	Getting Involved	
Carriage	Overawards and Overpayments	R2T4 Essentials	Basics of Determining Academic Calendars	Cyber Security
Claiborne			NCAA compliance for financial aid	Ask A FED

AGENDA

Wednesday, October 09, 2019

7:30 a.m. – 8:00 a.m.	New Member/Executive Board Continental Breakfast	Hospitality Suite
8:00 a.m. – 2:30 p.m.	New Aid Officer Workshop	Turfway Room
9:00 a.m. – 11:00 a.m.	Preconference Sessions	
	NASFAA U: Cost of Attendance (\$25 Fee)	Derby Room
	<ul style="list-style-type: none"> ▪ Presenter April Tretter, Bellarmine University ▪ Presenter Michelle Standridge, Spalding University ▪ Moderator April Tretter, Bellarmine University 	
	NASFAA U: Packaging (\$25 Fee)	Ellis Room
	<ul style="list-style-type: none"> ▪ Presenter Bryan Erslan, Eastern Kentucky University ▪ Moderator Rhonda Bryant, University of Kentucky 	
9:00 a.m. – 4:15 p.m.	Registration	In Front of Pegasus
10:00 a.m. – 12:00 p.m.	Exhibit Setup	Pre-Function Area
11:30 a.m. – 12:30 p.m.	Lunch on Your Own	
11:30 a.m. – 12:30 p.m.	New Aid Officer/Executive Board Lunch	Winner's Circle
1:00p.m. – 2:45 p.m.	Exhibits Open	Pre-Function Area
12:30 p.m. – 2:30 p.m.	Preconference Sessions	
	NASFAA U: Teach Grant (\$25 Fee)	Derby Room
	<ul style="list-style-type: none"> ▪ Presenter Sandy Neel ▪ Moderator Sandy Neel 	
	NASFAA U: Student Eligibility (\$25 Fee)	Turfway Room
	<ul style="list-style-type: none"> ▪ Presenter Brook Gupton, Campbellsville University ▪ Moderator Rhonda Bryant, University of Kentucky 	
2:45 p.m. – 4:00 p.m.	Opening Session / Welcome Bob Fultz, Georgetown College, KASFAA President Terri Jo Thomas, University of Kentucky, KASFAA Fall Conference Chair	Grand Ballroom
	General Session Communication with Diverse Social Economic Backgrounds	Grand Ballroom
	<ul style="list-style-type: none"> ▪ Presenter Deondra R. Wardelle O2TN1 (on to the next one) Consulting 	

- Moderator | Vickie Montgomery, Campbellsville University
- Description | During this session, leaders of KASFAA will discuss and determine what Diversity, Equity and Inclusion mean to KASFAA Leadership. In addition, conference attendees will determine how to model and apply what KASFAA believes about Diversity, Equity and Conclusion to help students of all backgrounds initiate and successfully complete a quality college education.

4:00 p.m. – 4:15 p.m.

Break

4:00 p.m. – 6:00 p.m.

Exhibits Open

Pre-Function Area

4:15 p.m. – 5:15 p.m.

Concurrent Sessions

Administrative Capabilities

Ellis Room

- Presenter | Dana Kelly, NASFAA
- Moderator | Biz Daniel, Great Lakes Higher Ed Corp
- Description | Administrative capability is at the heart of the Title IV regulations, encompassing many of the measures of an institution’s Title IV eligibility. Demonstrating administrative capability to participate in the Title IV programs involves virtually every office within an institution, making compliance a campus-wide commitment and responsibility. Come to this session to learn if our institution is hitting the regulatory mark.

Data Sharing Best Practices

Derby Room

- Presenter | Bryan Erslan, Eastern Kentucky University
- Presenter | Michael Birchett, Bluegrass Community and Technical College
- Presenter | Kevin Lamb, Centre College
- Moderator | Dave Bowman, U-Fi
- Description | Come hear from three schools about what they have implemented at their respective institutions. We will look at what the law says about data sharing.

Roadmap to Effective Emergency Aid

Turfway Room

- Presenter | April Tretter, Director Financial Aid & Dr. Sean McGreevey, Dean of Students, Bellarmine University
- Presenter | Lindsay Driskell, Director Financial Aid & Dr. Laura Smith, VP of Student Affairs, Jefferson Community and Technical College
- Presenter | Michelle Standridge, Director Financial Aid & Rick Hudson, Dean of Students, Spalding University
- Moderator | Michelle Standridge, Spalding University
- Description | Each year, postsecondary students’ success is threatened by unexpected financial hardships. Emergency funding has proven a cost-effective way to improve persistence, retention, and completion, as well as equity, inclusion, and students’ sense of belonging. Come hear from schools on how they started and Emergency Funding program, how it is managed and what they are doing to help meet the vision of the program. Also, what role does financial aid plan in the process and what other resources are schools providing their students.

Overawards and Overpayments

Carriage Room

- Presenter | David Bartnicki, U.S. Department of Education
- Moderator | Meredith Gercia, KHEAA/KHESLC
- Description | Overawards and overpayments are something that can cause your heart to skip a beat, and maybe even scream. This session will provide you tools on how to determine an overaward/overpayment and what you can do to resolve it.

5:30 p.m. - 6:30 p.m. President's Spooktacular Reception **Pre-Function Area**

6:30 p.m. Dinner on your own

8:30 p.m. Game Night **Grand Ballroom**

9:30 p.m. Hospitality Suite Open **Belmont Suite #774**

Thursday October 10, 2019

8:00 a.m. – 8:30 a.m. Grab and Go Breakfast **Pre-Function Area**

8:00 a.m. – 9:15 a.m. Exhibits Open **Pre-Function Area**

8:00 a.m. – 10:30 a.m. Late Registration **In Front of Pegasus**

8:30 a.m. – 9:00 a.m. Business Sessions

- Meredith Gercia - KHEAA/KHESLC **Carriage Room**
- Carla Strawn – PNC **Ellis Room**
- Amy Barnas - Campus Logic **Derby Room**

9:15 a.m. – 10:30 a.m. **General Session | Administering Adds, Drops & Withdrawals** **Grand Ballroom**

- Presenter | David Bartnicki, U.S. Department of Education
- Moderator | Bob Fultz, Georgetown College
- Description | This session will help you in determining when you can add aid or when you may have to remove aid if a student decides to add a class, drop a class, or complete withdrawals from your college/university. You will now know how to approach a student's financial aid should these circumstances arise.

10:30 a.m. – 10:45 a.m. Break

10:30 a.m. – 12:00 p.m. Exhibits Open **Pre-Function Area**

10:45 a.m. – 11:45 a.m. **Concurrent Sessions**

Student Loan Letters School Perspective **Turfway Room**

- Presenter | Bryan Erslan, Eastern Kentucky University
- Presenter | Nimmi Wiggins, University of Kentucky
- Moderator | Mark Riggs, SoFi
- Description | Discussion about student loan letters needed to be sent to students, how EKU and UK have handled.

Consumer Information

Ellis Room

- Presenters | Dana Kelly, NASFAA Vice President for Professional Development and Institutional Compliance
- Moderator | Raina Chezem, ELMresources
- Description | This topic continues to be among the Department of Education’s top audit findings. Come learn the ins and outs of consumer information requirements, including required disclosures of institutional information, financial assistance information, campus and fire safety, completion and transfer – out rates, and athletics.

KHEAA KY National Guard Processing Changes

Derby Room

- Presenter | Kate Ware, Student Aid Branch Manager, KHEAA
- Presenter | SSG Matthew Boone, GI Bill Manager, TCO, KY National Guard
- Moderator | Beth Mitchell, Transylvania University
- Description | Major system upgrades are live for all phases of Kentucky National Guard Tuition Award Program (KNGTP) administration. Staff from KHEAA and the KY Army National Guard will present information and tutorials on how these changes affect the KNGTP processing life cycle from initial soldier application, unit validation and school certification in the KYARNG State TA Portal, all the way through disbursement, refunds, aggregate tracking and reconciliation in MyKHEAA.

R2T4 Essentials

Carriage Room

- Presenter | David Bartnicki, U.S. Department of Education
- Moderator | Carla Strawn, PNC
- Description | Does the thought of completing an R2T4 terrify you? Are you being encouraged to take on the R2T4s? Do you want to move up in your office and take on new responsibilities? Then this is the session for you. Learn the basics of completing an R2T4. When an R2T4 is required, how you calculate an R2T4, as well as how and what aid is determined to be returned.

12:00 p.m. – 1:30 p.m.	Luncheon Business Meeting	Grand Ballroom
1:30 p.m. – 1:45 p.m.	Break	Grand Ballroom
1:45 p.m. – 2:45 p.m.	General Session Student Panel SFA Experiences	Grand Ballroom

Student Panelists:

Jessica Cates, Jonathan Garner, Elaine Harkey, Leslie Sprague

2:45 p.m. – 4:15 p.m.	Exhibits Open	Pre-Function Area
2:45 p.m. – 3:00 p.m.	Break	
3:00 p.m. – 4:00 p.m.	Concurrent Sessions	
	Basics of Determining Academic Calendars	Carriage Room
	<ul style="list-style-type: none"> ▪ Presenter David Bartnicki, U.S. Department of Education ▪ Moderator Amy Barnas, Campuslogic ▪ Description Are you responsible for reviewing the academic calendars at your school? Do you want to know some of the legalities of what needs to be in an academic calendar? Learn the basics of how a school is to setup and academic calendar and its effects on Title IV aid. I believe you will be surprised! 	
	Getting Involved in Your Association(s)!	Turfway Room
	<ul style="list-style-type: none"> ▪ Presenter April Tretter, Bellarmine University ▪ Presenter Danette Seale, Executive Director of Financial Aid at Carson-Newman University, Tennessee ▪ Presenter Michelle Standridge, Spalding University ▪ Moderator Michelle Standridge, Spalding University ▪ Description Have you ever wanted to get involved in KASFAA, SASFAA, or even NASFAA? Do you wonder if you have the time, talent, or experience to give back to your profession? Do you have ideas or new initiatives to share with your colleagues and wonder how to get started or go further? We invite you to join SASFAA President, Bryan Erslan as we learn about our state, regional, and national associations and how these dynamic organizations may benefit you both personally and professionally. Learn how to get started with varying committees, leadership roles, and even elected offices. There is something for every personality style, skill set, and stage of your career. If you have questions or just want to sit back and learn more, this is a session created just for you. 	
	Majoring in Money 2019	Ellis Room
	<ul style="list-style-type: none"> ▪ Presenter Joe Fries, Sallie Mae ▪ Moderator Janet Jones, University of Kentucky ▪ Description A National Study from Sallie Mae and conducted by Ipsos, focuses on payment methods, financial habits, and overall financial literacy of three groups of young adults: College students, college graduates, and those who began college but left before earning their degree. By examining the out-of-school young adults, we can shed light on potential growth in credit management skills that may lie ahead for current college students and whether gaps in financial literacy close after college. 	
	KAHOOT Veri' Fried'	Derby Room
	<ul style="list-style-type: none"> ▪ Presenter Elaine Brumback, KHEAA/KHSLEC ▪ Moderators Rhonda Bryant, University of Kentucky ▪ Description Come join us for a frightening game of KAHOOT to check your verification knowledge and find out how other institutions handle the same scary situations. 	

NCAA Compliance for Financial Aid **Claiborne Room**

- Presenter | Sarah Heberd, NCAA
- Moderator | April Tretter, Bellarmine University
- Description | Foundational presentation on NCAA compliance for financial aid.

4:00 p.m. – 4:15 p.m. **Break, with refreshments, in the Vendor Area** **Pre-Function Area**

4:15 p.m. Break Down Exhibit Area **Pre-Function Area**

4:15 p.m. – 5:15 p.m. **Concurrent Sessions**

ASK A FED **Claiborne Room**

- Presenter | David Bartnicki, U.S. Department of Education
- Moderator | Joe Fries, Sallie Mae
- Description | Whatever you do, do not fall asleep! This is your opportunity for one on one questions to be answered by our favorite federal trainer. Hopefully by getting the answers you need you can get some peaceful sleep.

Recognizing Hidden Bias in Professional Judgment **Derby Room**

- Presenter | Michael Birchett, Bluegrass Community and Technical College
- Moderator | Heidi Sission, Suntrust-Cognition
- Description | Professional judgment is a privilege of financial aid administrators that assists us in providing practical solutions for exceptional situations. This subjective authority produces options and opportunities in an otherwise objective regulatory environment. Our decisions are critical to those affected, but how often do we pause to consider how our minds come up with our answers? Where did our opinions come from? And are we as certain as we think we are? This session will discuss expanding research on hidden biases from leading psychologists in the field. We will explore the implications of some of their findings together as we examine our own decisions as they relate to professional judgment and the lives of folks we encounter every day.

Cyber Security (Top 10) **Carriage Room**

- Presenters | Lisa Cooper, University of Louisville
- Moderator | Patty Peterson, Citizen One
- Description | Financial Aid offices all over the state are dealing with sensitive data as part of their standard operating procedure. But no funding, no staff, and no time can be the right ingredients for a perfect disaster. Doing this work comes with lots of risk. In this session we will talk about a no non-sense approach to increased data protection. We will first discuss how to identify potential risks, and then how to protect your data without spending additional funding.

From Discord to Harmony: Five Strategies for Making Your Workplace Hum **Ellis Room**

- Presenters | Dr. Lavena Wilkin, Sullivan University
- Moderator | Angel Miller, Sullivan University
- Description | Explain the costs of unproductive conflict, discuss different styles of managing conflict, present ways to improve conflict management skills. Recognizing Managed Conflicts as Opportunities, becoming a compassionate listener, engaging in difficult conversations, valuing different conversations, valuing different points of view, using emotions as information, working together to resolve problems.

6:00 p.m. – 10:00 p.m. **Dinner and Halloween Party/Trivia** **Grand Ballroom**

10:00 p.m. Hospitality Suite Open **Belmont Suite #774**

Friday October 11, 2019

8:00 a.m. – 9:00 a.m. Breakfast **Grand Ballroom**

9:00 a.m. – 10:00 a.m. **Federal Update** **Grand Ballroom**

- Presenter | David Bartnicki, U.S. Department of Education
- Moderator | Bob Fultz, Georgetown College, KASF AA President
- Description | This session will discuss the latest and greatest news from the U.S. Department of Education. We will discuss 2019-20 processing updates, negotiated rulemaking and federal registers, recent electronic announcements and Dear Colleague Letters, along with any Title IV hot topics of the day. Time will be set aside for questions and answers.

10:00 a.m. – 11:15 a.m. **KHEAA/KHSLEC Update** **Grand Ballroom**

- Presenters | Gene Hutchins, Ted Franzeim, David Bailey and Becky Gilpatrick, KHEAA
- Moderator | Terri Jo Thomas, University of Kentucky, KASF AA Fall Program Chair
- Description | The spooky goes on at KHEAA. Updates, changes, new processes, funding for 19-20 and 20-21.

11:15 a.m. – 11:30 a.m. Announcements & Adjournment **Grand Ballroom**

12:15 p.m. – 2:15 p.m. **Post Conference Sessions**

NASF AA U: Professional Judgement (\$25 Fee)

Turfway Room

- Presenter | Angel Miller, Sullivan University
- Presenter | Beth Mekus, University of Kentucky
- Moderator | Rhonda Bryant, University of Kentucky

NASF AA U: Need Analysis (\$25 Fee)

Ellis Room

- Presenter | Kevin Lamb, Centre College
- Moderator | Kevin Lamb, Centre College

CONFERENCE MENU

WEDNESDAY

New Member Lunch: The Fiesta: Chicken and Beef strips with all the fixin's, Soft Tortillas, Spanish rice, refried beans, Tortilla chips and Salsa. Assorted Cakes and Cinnamon Crisps.

President's Reception: BBQ Meatballs, Vegetable Eggrolls, Assorted Cheese and Cracker Tray, Vegi Tray.

THURSDAY

Grab and Go Breakfast: Sausage, Egg and Cheese Biscuits, Assorted Muffins, Yogurt, Croissants w/fresh preserves, Freshly Brewed Coffee, Hot Teas, Assorted Bottle Juices & Water.

Luncheon: Grilled Chicken Alfredo, Tossed Garden Salad, Vegetable Du Jour and Side Dish, Rolls & Butter, Chocolate and Carrot Cakes.

Break with refreshments: Baked Cookies, Chocolate Brownies and Blondies, Ice Tea and Lemonade.

Prom Dinner: Pork Loin and London Broil with Pasta Salad, Seasoned Mashed Potatoes, Country Style Green Beans, Dessert Display.

FRIDAY

Breakfast: Fresh Seasonal Fruits, Farm Fresh Scrambled Eggs, Breakfast Potatoes, Crisp Bacon Strips, Buttermilk Biscuits, gravy, Fruit Preserves and Butter.

***The chef has been notified of any special dietary needs that were included on the conference registration forms, including vegetarian options.*



Holiday Inn Louisville East

502-426-2600

Hihurstbourne.com

Ground Floor
Floor Plan

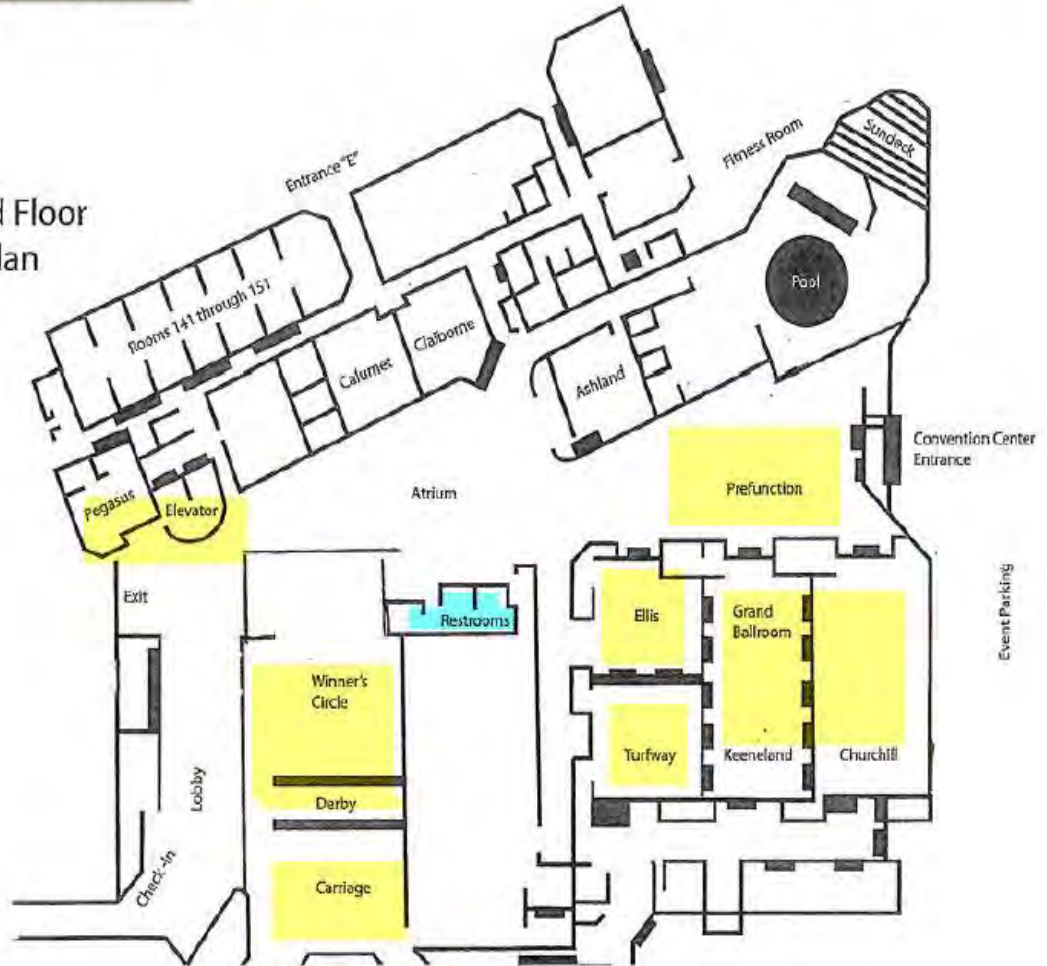

KASFAA Executive Board

Bob Fultz, President
Georgetown College

Rhonda Bryant, Vice President of Training
University of Kentucky

Michelle Standridge, President Elect
Spalding University

April Tretter, Immediate Past President
Bellarmine University

Brooke Gupton, Secretary
Campbellsville University

Mark Messingschlager, Treasurer
Thomas More University

KASFAA Board of Directors

Toya Bailey, Four-Year Public School Representative
University of Louisville

Robyn Sollberger, Private School Representative
Campbellsville University

Michael Barlow, Two-Year Public School Representative
Elizabethtown Community & Technical College

Joni Penland, Proprietary School Representative
Galen College of Nursing

Biz Daniel, Non-school Representative
Scholarnet

Committees and Chairs

Articles & Bylaws

Brooke Gupton, Campbellsville University

Audio/Visual

Beth Mitchell, Transylvania University
Michael Birchett, Bluegrass Community and Technical College

Awards

Charles Vinson
Murray State (retired), KHEAA/KHESLC Board

Budget & Finance

Kevin Lamb, Centre College

Communications

Hannah Mullins, Georgetown College

Diversity

Vickie Montgomery, Campbellsville University

Legislative Issues

Erin Klarer, KHEAA/KHESLC

Long Range Planning

Kristie Hughes, Western Kentucky University

Membership

Janet Jones, University of Kentucky

Nominations

April Tretter, Bellarmine University

Outreach

Brittini Wise Heines, University of Louisville

Program, Fall

Terri Jo Thomas, University of Kentucky

Program, Spring

Michelle Standridge, Spalding University
Beth Mitchell, Transylvania University

Site Selection

Chester Priest, KHEAA/KHESLC

Training, High School Counselor

Beth Mekus, University of Kentucky
Angel Miller, Sullivan University

Training, New Aid & Support Staff

Beth Mekus, University of Kentucky

Vendor / Sponsor

April Tretter, Bellarmine
Carla Strawn, PNC

Website / Technology

Jason Tretter, KHEAA/KHESLC

KASFAA HALL OF FAME

Term	President	Vice President	Secretary	Treasurer
1967-1968	Barry Dixon		Ruth Everling	Harry Beck
1968-1969	Harry Beck		Sister Rosalin Thieneman	Charles Day
1969-1970	Blake Tanner		Paul Borden	Wilson Evans
1970-1971	Lee Watkins		Elinor Starr	Wilson Evans
1971-1972	Bob Halsey		Violetta Shearer	Wilson Evans
1972-1973	Elinor Starr		Violetta Shearer	Herb Vescio
1973-1974	James Ingle		Ruth Blackburn	Herb Vescio
1974-1975	John Heneisen		Joyce Bryan	Herb Vescio
1975-1976	Elmer Anderson		Joyce Bryan	Herb Vescio
1976-1977	Paul Borden		Mona Logsdon	Herb Vescio
1977-1978	Malcolm Wilson		Mona Logsdon	Herb Vescio
1978-1979	Johnny McDougal		Dave Forman	Herb Vescio
1979-1980	Mona Logsdon		Alice Houston	Herb Vescio
1980-1981	Dave Forman		Connie Williams	Pat Arauz
1981-1982	Phyllis Chandler		Connie Williams	Elinor Starr
1982-1983	Peggy Fain		Joanne Story	Elinor Starr
1983-1984	Herb Vescio		Joyce Gordon	Elinor Starr
1984-1985	Lee Watkins		Judy Deines	Charles Vinson
1985-1986	Betsy Irby		Judy Deines	Charles Vinson
1986-1987	Paul Borden		Susan Luhman	Charles Vinson
1987-1988	Connie Williams		Susan Luhman	Nimmi Wiggins
1988-1989	Charles Vinson		Barbara Scheidt	Nimmi Wiggins
1989-1990	Bob Halsey		Barbara Scheidt	Leslie Schmidt
1990-1991	Nimmi Wiggins		Melinda Stuber	Leslie Schmidt
1991-1992	Judy Deines		Melinda Stuber	Barbara Scheidt
1992-1993	Leslie Schmidt Kaelin		Donna Blair	Barbara Scheidt
1993-1994	Marilyn Clark		Donna Blair	Janet Jones
1994-1995	Barbara Smith		Denise Krebs	Janet Jones
1995-1996	Ron Duvall		Denise Krebs	Barbara Scheidt
1996-1997	Tim Rhodes		Sandra Neel	Barbara Scheidt
1997-1998	Doug Cleary		Sandra Neel	Chris Tolson
1998-1999	Barbara Scheidt		Sue Mattox	Chris Tolson
1999-2000	Anthony Bowles		Sue Mattox	Chris Tolson
2000-2001	Sandra Neel		Zelena O'Sullivan	Chris Tolson
2001-2002	Michael Morgan		Lissa Caldwell	Heather Boutell
2002-2003	Nancy Melton		Lissa Caldwell	Heather Boutell
2003-2004	Ron McMakin	Shelley Park	Lissa Caldwell	Jennifer Cosens
2004-2005	Heather Boutell	Runan Pendergrast	Lissa Caldwell	Jennifer Cosens
2005-2006	Shelley Park	Bryan Erslan	Lissa Caldwell	Jennifer Cosens
2006-2007	Runan Pendergrast	Rick Wilson	Karyn Yates	Jennifer Cosens
2007-2008	Bryan Erslan	Cindy Burnette	Karyn Yates	Andrea Spry
2008-2009	Jennifer (Cosens) Priest	Katie Conrad	Vickie Montgomery	Andrea Spry
2009-2010	Chester Priest	Aaron Gabehart	Vickie Montgomery	Andrea Spry
2010-2011	Dave Cecil	Laura Keown	Rhonda Bryant	Chris Tolson
2011-2012	Aaron Gabehart	Kristie Hughes	Rhonda Bryant	Lindsay Driskell
2012-2013	Chris Tolson	Tiffany Hornberger	Rhonda Bryant	Lindsay Driskell
2013-2014	Katie Conrad/Runan Pendergrast	Tiffany Hornberger	Rhonda Bryant	Lindsay Driskell
2014-2015	Kristie Hughes	Judy Bradley	Kate Ware	Lindsay Driskell
2015-2016	Laura Keown	Michael Birchett	Kate Ware	Mayme Clayton
2016-2017	Angela Black	Robin Buchholz	Brooke Gupton	Mayme Clayton
2017-2018	Michael Birchett	Kevin Lamb	Brooke Gupton	Michelle Standridge
2018-2019	April Tretter	Robin Buchholz	Brooke Gupton	Michelle Standridge

HONORARY LIFETIME MEMBERS

2019	Cindy Burnette	2002	Kathy Eagan
2019	Jason Tretter	2002	Tim Rhodes
2018	Denise Krebs Sullivan	2001	Londa Wolanin
2017	Dave Cecil	2001	Jane Stewart
2016	Mary Givhan	2001	Janis Eddington
2016	Betty Parke	2001	Susan Luhman
2016	Nancy Melton	2001	Barbara Smith
2015	Shelley Park	2000	Paul Dameron*
2015	Rick Wilson	2000	William Boyd*
2015	Donna King	2000	Barbara Scheidt
2014	Pat Arauz	2000	Lee Watkins
2014	Jackie Marshall	2000	Davis Stapleton
2014	Becky Carson	1999	Paul Borden
2014	Elaine Larson	1998	Jeannette Jennings
2012	Karyn Yates*	1998	G. Blake Tanner
2012	Shawn Anderson	1998	Herb Vescio*
2012	Sue Mattox	1997	Johnny McDougal
2012	Sandy Barlow	1997	D. Wayne Sisk
2012	Vivian Hill*	1997	Elinor Starr*
2011	Fern Bishop	1997	Larry Reeder
2011	Marion Shute	1997	Cyrintha Terry*
2010	Terri Parchment	1997	Peggy Fain
2010	Theresa Hulsey	1997	Joyce Bryan
2010	John Holder	1996	Elmer Anderson*
2010	Mary Anne Olson	1995	Bobby Halsey
2009	Rosemary Tutt	1994	Don Mills
2008	Charles Vinson	1993	Jack Marema
2008	Ron McMackin	1992	Gus Paris
2008	Carol Becker	1992	Dave Forman
2008	Kathryn (Kitty) Hall	1990	Connie Williams
2008	Kathy Hodges	1988	Sister Rosalin Thieneman
2006	Rosemary Ewen	1988	Keith Johnson
2006	Dr. Joe McCormick	1988	Alice Houston
2006	Harold Stice*	1988	Sarah B. Crouse
2005	Rhonda Swim	1987	Vernon Hurt
2005	Marian Spencer	1986	Nancy Stacy*
2005	Harold Patterson*	1986	Sister Marilyn Pierson
2005	Judy Deines	1986	Barry Dixon
2004	Sandra J. Neel	1984	James Ingle*
2004	Marilyn Clark-Watkins	1983	John Heneisen
2004	Rich Nickel	1982	Violetta Shearer*
2003	Ron Duvall*	1981	A.J. Thurman*
2002	June Eisemann		<i>*Deceased</i>

2002 Betsy Irby
2002 Wilson Evans*

HERB VESCIO DISTINGUISHED SERVICE AWARD RECIPIENTS

1985	Herb Vescio	Eastern Kentucky University
1986	Elinor Starr	Spalding University
1987	Blake Tanner	University of Louisville
1988	Johnny McDougal	Murray State University
1989	Lee Watkins	Western Kentucky University
1990	Connie Williams	Georgetown College
1991	Charles Vinson	Murray State University
1992	Joyce Bryan	KHEAA
1993	Bobby Halsey	University of Kentucky
1994	Paul Borden	KHEAA
1995	Peggy Fain	Transylvania University
1996	Barbara Scheidt	Western Kentucky University
1997	Barbara Smith	Asbury College
1998	Judy Deines	Jefferson Community College
1999	Susan Luhman	Eastern Kentucky University
2000	Tim Rhodes	Morehead State University
2001	Ron Duvall	KHEAA
2002	Marilyn Clark-Watkins	Western Kentucky University
2003	Nimmi Wiggins	University of Kentucky
2004	Rhonda Swim	Morehead State University
2005	Dave Cecil	Transylvania University
2006	Leslie Kaelin	University of Louisville School of Medicine
2007	Dr. Joe L. McCormick	KHEAA/The Student Loan People
2008	Patricia Arauz	University of Louisville
2009	Heather Boutell	Bellarmino University
2010	Michael Morgan	KCTCS
2011	Chris Tolson	Campbellsville University
2012	Shelley Park	Eastern Kentucky University
2013	Jennifer Priest	Transylvania University
2014	Sandra Neel	University of Louisville
2015	Chester Priest	KHEAA/KHESLC
2016	Runan Pendergrast	Bluegrass Community and Technical College
2017	Anthony Bowles	Kentucky State University
2018	Carl Rollins	KHEAA/KHESLC
2019	Laura Keown	Centre College

Safe Travels!

Join us at the Spring Conference!

April 15- 17, 2020 at the Clarion Hotel

Lexington, KY

